

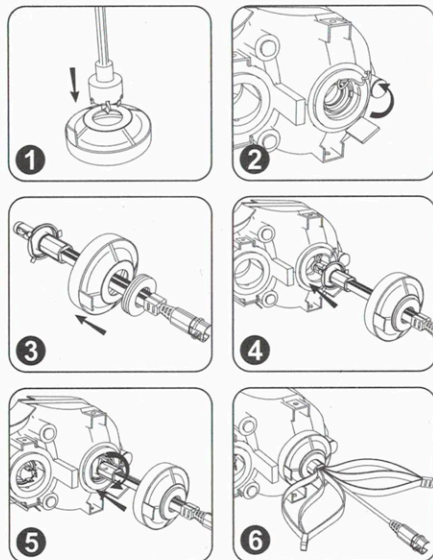

GEN3 LED HEADLIGHT BULB CONVERSION KIT INSTALLATION GUIDE

Installation guide for "CLIP ON"
Bulbs: H1, H3 H4 & H7



Installation guide for "TWIST ON"
Bulbs: 9004, 9005/HB3, 9006/HB4
9007, 9012, H13, H11

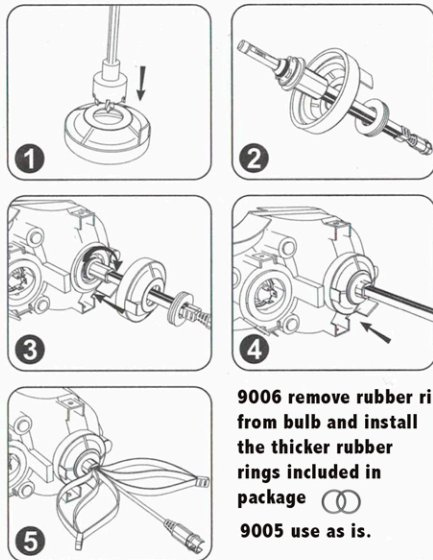

9006 remove rubber rings from bulb and install the thicker rubber rings included in package 9005 use as is.

(Trucks Equipped With Sealed Headlight Units Will Need To Modify Headlight Cap & use sealing rings)

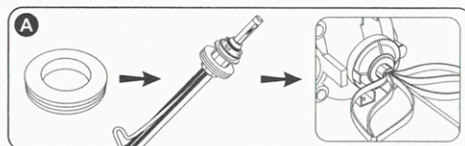

Choose Ring A if you do not have enough space for the Black heat conductor to fit inside sealed headlight housing. Sealing Ring will slide over the heat conductor.

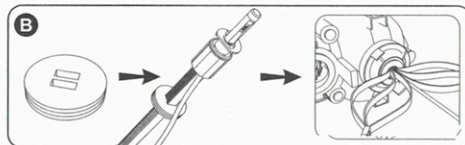

Choose Ring B if you have space inside the headlight housing for the Black Heat conductor. The sealing ring will slide over the braid only.

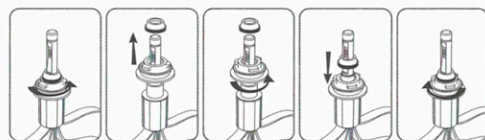

LED Bulb Design Allows For 4 Way Adjustability For Optimum Light Output In Any Headlight Housing.

Unscrew removable top base, lift base adjust base by turning left or right align the base notch with the bulb aligning rail. Screw top base and install headlight in housing.

WWW.NOVA-LUXINDUSTRIES.COM

RUBBER GROMMETS ARE PROVIDED TO ENSURE FULL EXTERIOR EXPANSION OF WOVEN BRAIDS. DO NOT PUSH WOVEN COPPER BRAIDS INSIDE ENCLOSED HOUSINGS AS THIS WILL NOT LET THE WOVEN BRAIDS DISPERSE THE HEAT AND RESULT IN PREMATURE BULB BURN OUT. WARRANTY WILL NOT BE VALID IF BRAIDS ARE INSTALLED INCORRECTLY AND NOT FANNED PROPERLY.



GEN3 LED HEADLIGHT BULB CONVERSION KIT INSTALLATION GUIDE

Installation guide for "CLIP ON"
Bulbs: H1, H3 H4 & H7

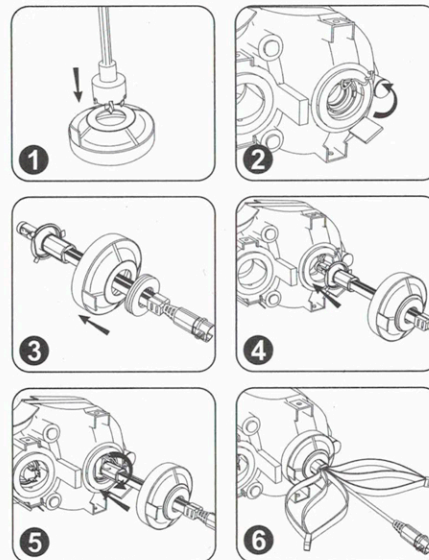

Installation guide for "TWIST ON"
Bulbs: 9004, 9005/HB3, 9006/HB4
9007, 9012, H13, H11

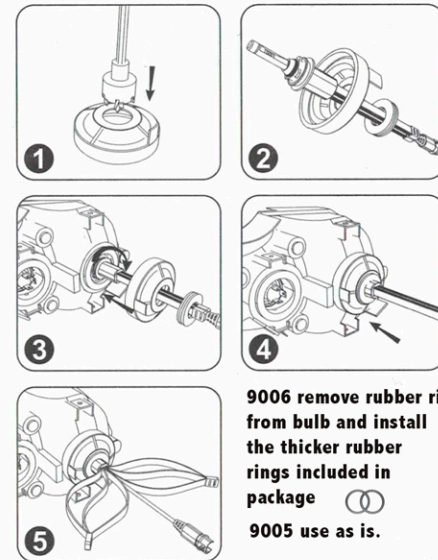

9006 remove rubber rings from bulb and install the thicker rubber rings included in package 9005 use as is.

(Trucks Equipped With Sealed Headlight Units Will Need To Modify Headlight Cap & use sealing rings)

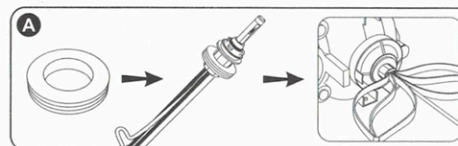

Choose Ring A if you do not have enough space for the Black heat conductor to fit inside sealed headlight housing. Sealing Ring will slide over the heat conductor.

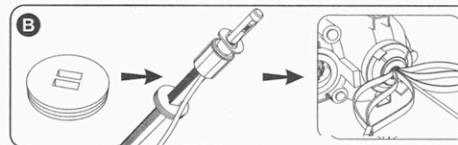

Choose Ring B if you have space inside the headlight housing for the Black Heat conductor. The sealing ring will slide over the braid only.

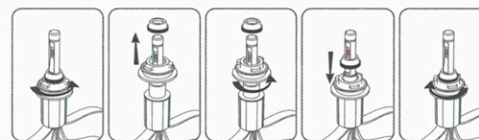

LED Bulb Design Allows For 4 Way Adjustability For Optimum Light Output In Any Headlight Housing.

Unscrew removable top base, lift base adjust base by turning left or right align the base notch with the bulb aligning rail. Screw top base and install headlight in housing.

WWW.NOVA-LUXINDUSTRIES.COM

RUBBER GROMMETS ARE PROVIDED TO ENSURE FULL EXTERIOR EXPANSION OF WOVEN BRAIDS. DO NOT PUSH WOVEN COPPER BRAIDS INSIDE ENCLOSED HOUSINGS AS THIS WILL NOT LET THE WOVEN BRAIDS DISPERSE THE HEAT AND RESULT IN PREMATURE BULB BURN OUT. WARRANTY WILL NOT BE VALID IF BRAIDS ARE INSTALLED INCORRECTLY AND NOT FANNED PROPERLY.