

ASSEMBLY INSTRUCTIONS

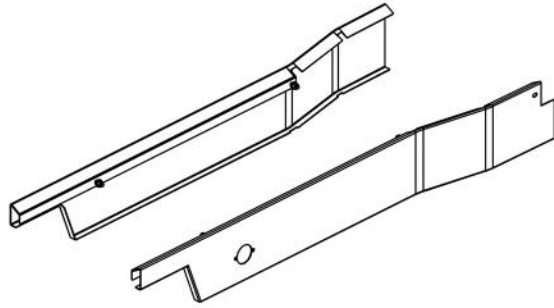

MODELS & YEARS:

49X SBA 2021&UP
SHORT HOOD, DAY CAB, DOUBLE SIDE EXHAUST

TITLE:
CAB PANEL INSTALLATION

DWG. NO.	NAME	DATE	SIZE A
	G.L.	2021-03-25	
SCALE: 1:12	WEIGHT: LBS	SHEET: 1 OF 4	

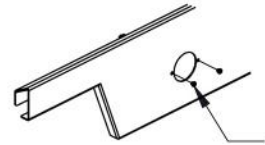
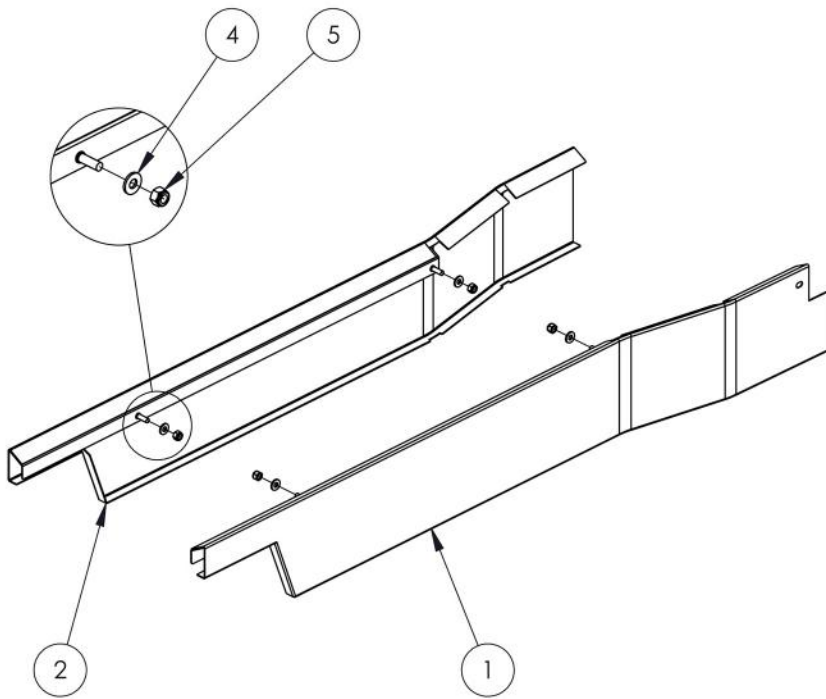

ITEM	DESCRIPTION	QTY
1	CAB PANEL 6"	1
2	CAB PANEL 6"	1
3	BOLTS KIT	1
4	FLAT WASHER 1/4	4
5	NYLON LOCK NUT, 1/4-20 UNC	4

TITLE: CAB PANEL INSTALLATION			
SIZE	DWG. NO.		
A	NAME	DATE	REV
	DRAWN BY	G.L.	2021-03-25
		0	-
	SCALE: 1:8	WEIGHT: LBS	SHEET: 2 OF 4

INSTALLATION INSTRUCTIONS

**BE SURE TO READ AND UNDERSTAND ALL INSTRUCTIONS
BEFORE BEGINING INSTALLATION**

CAUTION:

- TO PREVENT DAMAGES TO THE PIECES, REMOVE STAINLESS STEEL PROTECTIVE SHEET ONLY WHEN THE INSTALLATION IS COMPLETED.

REQUIRED MATERIAL: SCREWDRIVER WITH REQUIRED BITS AND WRENCHES

INSTRUCTIONS:

- 1- REMOVE THE ORIGINAL LEFT AND RIGHT CABIN PANELS.
- 2- REMOVE BLOCK HEATER PLUG(S) FROM THE HEATER BLOCK ON THE LEFT SIDE OF THE TRUCK. KEEP SCREWS AND WASHERS FOR INSTALLATION OF THE NEW PANELS. THEY WILL BE USE IN A FURTHER STEP.
- 3- INSTALL STAINLESS STEEL CAB PANELS IN THE ORIGINAL CABIN HOLES ON TRUCK. INSTALL WASHERS AND NUTS ON STUDS WELDED ON THE PANEL FIRST AND USE SCREW AND WASHERS KEPT AT STEP 1 FOR THE HOLE AT THE END OF THE PANEL. ADJUST POSITION AND TIGHT ALL NUTS AND SCREWS FIRMLY.
- 4- REMOVE SECTION OF THE STAINLESS STEEL PROTECTIVE SHEET AT BLOCK HEATER SOCKET(S) LOCATION. INSTALL BLOCK HEATER PLUG(S) ON CAB PANEL WITH RIVETS. IF THE TRUCK DOESN'T HAVE BLOCK HEATER PLUGS, GO TO STEP 5
- 5- CHECK THAT ALL SCREWS AND NUTS ARE WELL TIGHT.
- 6- REMOVE REMAINING STAINLESS STEEL PROTECTIVE SHEET.

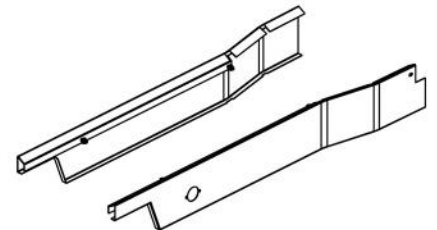

<p>MODELS & YEARS: 49X SBA 2021&UP SHORT HOOD, DAY CAB, DOUBLE SIDE EXHAUST</p>		DWG. NO.	SIZE A
	TITLE: CAB PANEL INSTALLATION	NAME	DATE
	DRAWN BY G.L.	2021-03-25	
	SCALE: 1:16	WEIGHT: LBS	SHEET: 3 OF 4