

ASSEMBLY INSTRUCTIONS

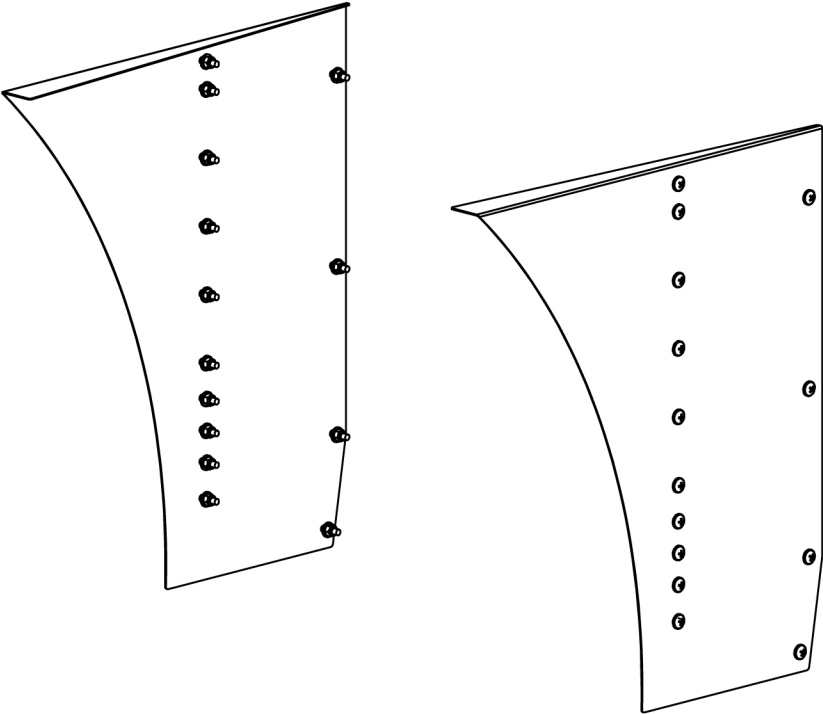

MODELS & YEARS:
379 1987 TO 2007
127BBC LONG HOOD

TITLE:
PANEL INSTALLATION

DWG. NO.		SIZE A
NAME		DATE
DRAWN BY	G.L.	
SCALE: 1:8	WEIGHT: LBS	SHEET: 1 OF 4

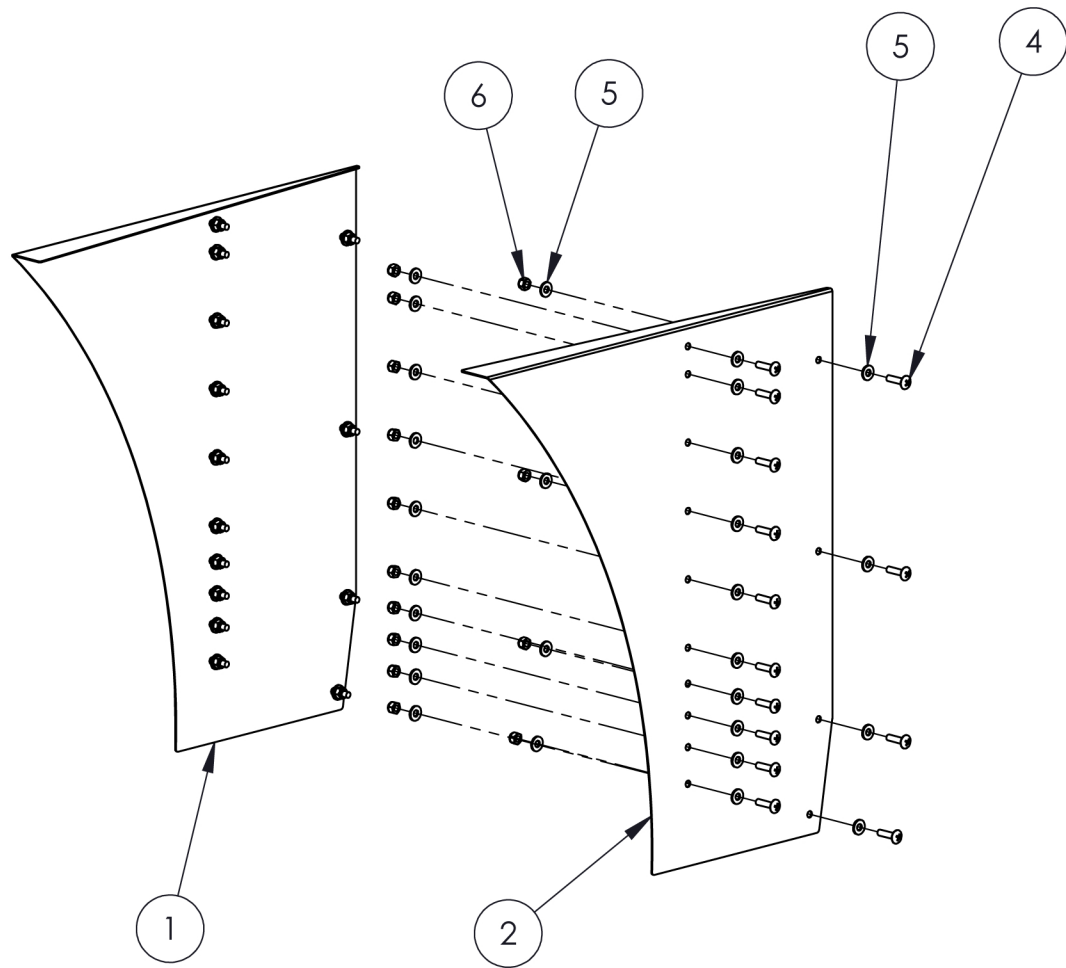

ITEM	C7122006	S7122006	DESCRIPTION	QTY	TITLE: PANEL INSTALLATION				
1			LOWER HOOD PANEL	1					
2			LOWER HOOD PANEL	1					
3				1					
4			TRUSS PHILIPS 1/4-20NCX1"SS	28	A	SIZE DWG. NO.			
5			FLAT WASHER 1/4	56		NAME DATE		REV	DATE
6			NYLON LOCK NUT, 1/4-20 UNC	28		DRAWN BY G.L.		0	-
					SCALE: 1:8		WEIGHT: LBS		SHEET: 2 OF 4

INSTALLATION INSTRUCTIONS

BE SURE TO READ AND UNDERSTAND ALL INSTRUCTIONS
BEFORE BEGINING INSTALLATION

CAUTION:

- TO PREVENT DAMAGES TO THE PIECES, REMOVE STAINLESS STEEL PROTECTIVE SHEET ONLY WHEN SPECIFIED IN THE INSTRUCTIONS.

REQUIRED MATERIAL: DRILL AND DRILL BITS, SCREWDRIVER WITH REQUIRED BITS, WRENCHES, SOAPY WATER, CLEAN PIECES OF CLOTH (NO PAPER TISSUES) AND ISOPROPYL ALCOHOL

INSTRUCTIONS:

- 1- READ 3M INSTRUCTIONS (LAST PAGE)
- 2- PUT PANEL ON TRUCK TO MAKE SURE THAT IT IS CONFORM TO THE PANEL ALREADY INSTALLED.
- 3- REMOVE RIVETS FROM THE BOTTOM PANEL INSTALLED ON TRUCK (SEE YOUR DEALER FOR THE BEST WAY TO REMOVE THE RIVETS)
- 4- ENLARGE RIVET HOLES TO Ø9/32 TO BE ABLE TO INSERT THE 1/4-20 PHILIPS SCREWS.
- 5- CLEAN EXISTING LOWER HOOD PANEL WHERE THE NEW STAINLESS STEEL PANEL WILL BE. SEE 3M INSTRUCTIONS FOR CLEANING PROCEDURE.
- 6- REMOVE PORTION OF STAINLESS STEEL PROTECTIVE SHEET WHERE THE SCREWS WILL BE INSTALLED.
- 7- REMOVE ABOUT 2 INCHES OF THE BACKING AT EACH ENDS OF THE 3M TAPE AND FOLD TOWARD THE OUTSIDE OF THE PANEL SO IT WILL BE EASY TO REMOVE THE BACKING WHEN THE PIECE WILL BE IN PLACE. SEE 3M INSTRUCTIONS (LAST PAGE)FOR INSTALLATION TIPS.
- 8- POSITION PANEL AND PRESS LIGHTLY TO HOLD IN PLACE.
- 9- SCREW PANEL IN PLACE WITH SUPPLIED HARDWARE. THEN PRESS FIRMLY TO GLUE PANEL IN PLACE.
- 10- REMOVE REMAINING STAINLESS STEEL PROTECTIVE SHEET.

MODELS & YEARS: 379 1987 TO 2007 127BBC LONG HOOD			DWG. NO.	SIZE A
	TITLE: PANEL INSTALLATION		NAME	DATE
			DRAWN BY G.L.	
			SCALE: 1:12	WEIGHT: LBS SHEET: 3 OF 4

3M TAPE

IMPORTANT: MAKE SURE THAT YOUR HANDS ARE CLEAN OR WEAR CLEAN GLOVES TO INSTALL THE 3M 2 WAYS TAPE

SURFACE PREPARATION PROCEDURE FOR STICKING 3M ADHESIVE TAPE

Note: Do not use BRAKE CLEANER to clean surface.

- The truck should be in an environment having an ambient temperature of 15 to 30 degrees C.
- Clean well the surface with soapy water. Completely dry the surface.
- Take a clean piece of cloth (no papers tissue), generously dip in isopropyl alcohol and clean the surface till there is no dirt on the cloth. Let the surface dry out (maximum 5 minutes).
- Stick the accessory on to the cleaned surface very carefully and press the accessory on the surface with hands, (The accessory will stick instantly).
- Let the accessory dry for 24 hours for maximum adhesion, before putting the truck in service.

3M PARTS STICKING TIP

DO NOT ENTIRELY REMOVE THE 3M PROTECTIVE TAPE BEFORE PLACING THE PART. THE ADHESIVE IS VERY STRONG AND TRYING TO REMOVE A MISPLACED PART WILL RESULT IN THE DAMAGE OF THAT PART. FOLLOW THE BOTTOM TIPS FOR EASY ADJUSTMENT AND INSTALLATION

USE THESE TIPS TO LIMIT THE ADHESIVE SURFACE MAKING IT EASY TO REMOVE THE PART TO RE-ADJUST IT, AND ONCE IN PLACE, IT WILL FACILITATE EXPOSING THE REMAINING ADHESIVE WITHOUT HAVING TO DISPLACE THE PART.

- 1-On the part, remove 2" of the protective tape at one end of each short lengths of 3M tape or each end for longer 3M lengths, folding it so it exceeds the part acting as a pull tab.
- 2-Place the part at the proper location on the truck, once the part is to your satisfaction, hold it in place and slowly pull the exceeding protective tape exposing the remaining 3M adhesive while pressing firmly.
- 3-Go over the part again, firmly pressing on the part to ensure good adhesiveness. Pay particular attention to the ends.